

J & F Galvanised Closed Spelter Socket

- Sizes up to 1 1/8 " inclusive are produced with ZG 35 CrMo or ZG42 CrMo Steel.
- Sizes from 1 1/4" above are produced with ZG16Mn Steel.
- Can be supplied with MPI and Ultrasonic inspection reports if requested at time of manufacture.
- Sizes up to 1 1/8" have no grooves from 1 1/4" and above are supplied with grooves.

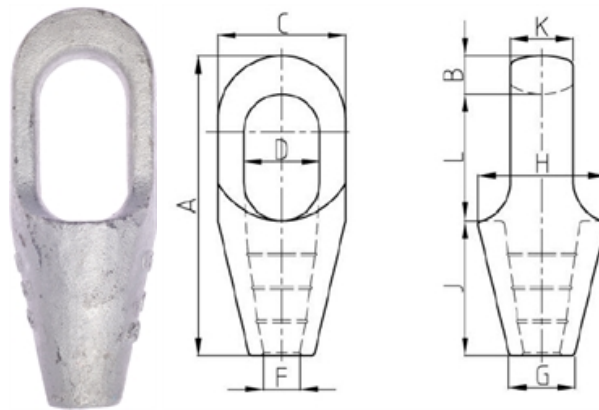

Code	Wire Rope Dia		M.B.L	A	B	C	D	F	G	H	J	K	L	Weight
	(mm)	(inches)	(tonnes)	(mm)	(mm)	(mm)	(mm)	(mm)	(mm)	(mm)	(mm)	(mm)	(mm)	(kg)
SOC-01	6-7	1/4	4.5	114.3	12.7	38.1	22.4	9.7	17.5	39.6	57.1	12.7	44.5	0.23
SOC-02	8-10	5/16-3/8	12.0	125.2	15.8	42.9	24.6	12.7	20.6	42.9	57.2	17.5	52.3	0.34
SOC-03	11-13	7/16-1/2	20.0	139.7	17.5	50.8	29.6	14.2	23.9	50.8	63.5	22.4	58.7	0.68
SOC-04	14-16	9/16-5/8	30.8	160.3	20.6	66.8	35.8	17.5	28.5	60.5	76.2	25.4	63.5	1.13
SOC-05	18	3/4	43.5	193.6	26.9	76.2	42.2	22.4	31.8	69.9	88.9	31.8	77.7	1.92
SOC-06	20-22	7/8	65.3	222.3	31.8	92.2	49.3	25.4	38.1	82.6	101.6	38.1	88.9	3.28
SOC-07	24-26	1	81.6	251.0	35.1	104.9	58.4	28.7	44.5	95.3	114.3	44.5	101.8	4.76
SOC-08	28-30	1-1/8	100.0	279.4	38.1	114.3	65.0	31.8	50.8	104.9	127.0	50.8	114.3	6.46
SOC-09	32-35	1-1/4-3/8	136.0	307.1	41.4	127.0	71.4	38.1	57.2	121.6	139.7	57.2	127.0	8.95
SOC-10	38	1-1/2	170.0	354.1	49.3	136.7	81.0	41.4	69.9	133.3	152.4	63.5	152.4	13.2
SOC-11	40-42	1-5/8	188.0	384.3	54.1	146.1	82.6	44.5	76.2	139.7	165.1	69.9	165.1	16.3
SOC-12	44-48	1-3/4-1-7/8	268.0	438.2	55.6	171.5	95.3	50.8	79.5	162.5	190.5	76.2	192.0	26.0
SOC-13	50-54	2-2-1/8	309.0	501.7	62.0	193.8	111.3	57.2	95.3	187.5	215.9	82.6	223.8	35.8
SOC-14	56-60	2-1/4-2-3/8	360.0	546.1	69.9	218.9	127.0	66.8	104.9	210.4	228.6	92.2	247.7	47.6
SOC-15	64-67	2-1/2-2-5/8	424.0	596.7	79.3	241.3	139.7	73.2	114.3	235.0	247.7	101.6	269.8	63.5
SOC-16	70-73	2-3/4-2-7/8	549.0	644.4	79.3	273.1	158.8	79.3	124.0	258.8	279.4	124.0	285.8	99.8
SOC-17	75-80	3-3-1/8	656.0	688.9	85.6	292.1	171.5	85.9	133.4	282.1	304.8	133.4	298.5	125.0
SOC-18	82-86	3-1/4-3-3/8	750.0	743.0	101.6	311.2	184.2	92.0	146.1	311.2	330.2	146.1	311.2	142.0
SOC-19	88-92	3-1/2-3-5/8	820.0	787.4	101.6	330.2	196.9	98.6	160.3	330.2	355.6	158.8	330.2	181.0
SOC-20	94-102	3-3/4-4	1005.0	844.6	108.0	362.0	215.9	108.0	184.2	362.0	381.0	177.8	355.6	246.0

